

6 Port Gigabit managed Industrial Switch



Overview

6-port industrial Ethernet switch that provides 4 Gigabit ports, 2 Gigabit optical ports, it is especially suitable for applications where it is difficult to provide AC power and has high requirements on wiring costs. Corrugated high-strength aluminum profile housing, IP40 grade, low power design, seismic rail mounting, -40°C-75°C work temperature, can work in harsh environments;

Can also support rich network management functions: RSTP, VLAN, QoS, SNMPv1/v2c/v3, IEEE802.1X, SSH/SSL, port mirroring, port aggregation etc. switching and security management features make it a reliable solution for smart traffic, video surveillance and other harsh industrial environments

Installation method:

Before installation, confirm the operating environment of the equipment: power supply voltage, installation space, installation method . Please carefully confirm the following installation requirements:

Check if there are cables and connectors required for installation

Check whether the cable is in place (not more than 100m) according to reasonable configuration requirements.

The product does not provide installation components. Users need to prepare components of the selected installation type: screws, nuts and tools to ensure reliable installation.

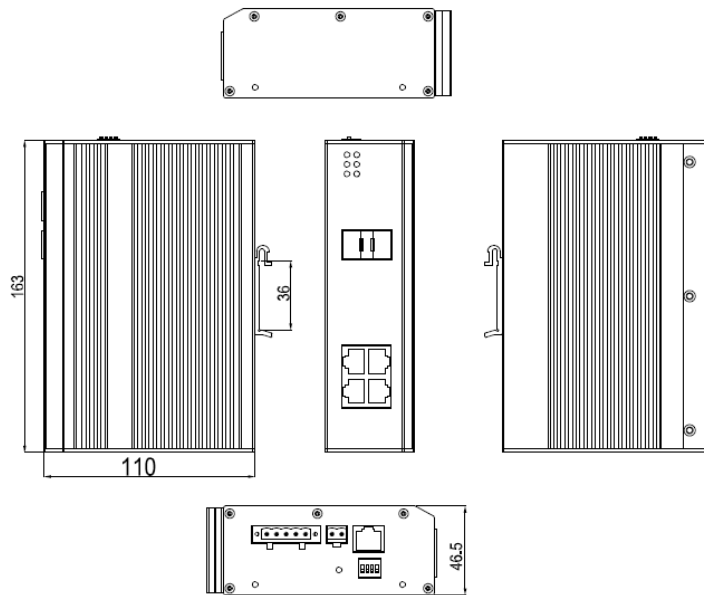

Power access

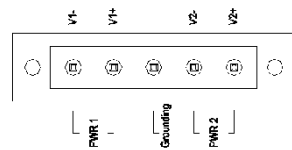

5pin 5.08mm terminal

Input range: 12-56VDC

P1&P2 dual redundant power supply,

Support reverse connection protection

Ground protection

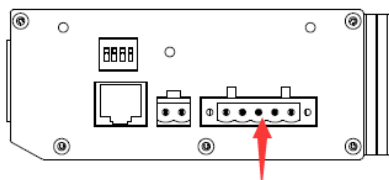

Connect the ground port to

Rail mounting

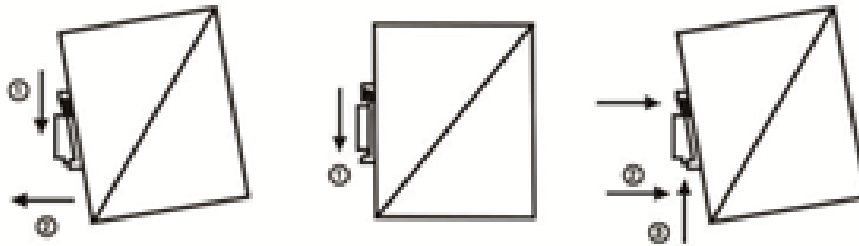

Hardware specification

Standards	<p>IEEE 802.3: Ethernet Media Access Control (MAC) Protocol</p> <p>IEEE 802.3i: 10BASE-T Ethernet</p> <p>IEEE 802.3u: 100BASE-TX Fast Ethernet</p> <p>IEEE 802.3ab: 1000BASE-T Gigabit Ethernet</p> <p>IEEE 802.3z: 1000BASE-X Gigabit Ethernet(optical fiber)</p> <p>IEEE 802.3ad: Standard method for performing link aggregation</p> <p>IEEE 802.3x: Flow control</p> <p>IEEE 802.1p: LAN Layer 2 Qos/Cos protocol for traffic prioritization (multicast filtering)</p> <p>IEEE 802.1q: VLAN Bridge Operation</p> <p>IEEE 802.1d: STP Spanning Tree</p> <p>IEEE 802.1s: MSTP Spanning Tree</p> <p>IEEE 802.1w: RSTP Spanning Tree</p>
Exchange characteristics	MAC address: 8K
	Port Cache: 4Mbit

	Backplane bandwidth: 12Gbps
	Switching Delay: <5us
	100Mbps forwarding speed: 148810pps Gigabit forwarding speed: 1488100pps 100M maximum filter speed: 148810pps Gigabit maximum filtration speed: 1488100pps
Port	RJ45 port: 4 10/100/1000Base-Tx RJ45 ports Optical port: 2 1000Base-X (SFP)
Front panel indicator	Power indicator: P1,P2 System indicator: SYS Alarm indicator: ALM Interface indicator: Link&Act F1~F2 Network port indicator: Link&Act 1~4
Power supply	Input voltage: 12- 56V DC Input method: plug-in 5-core 5.08mm pitch terminal block Support dual DC power backup, built-in over current protection Power supply anti-reverse connection
Power consumption	Full load power: 6W
Physical characteristics	Housing: IP40 grade protection, corrugated high strength metal housing
	Installation: DIN rail mounting
	Dimensions (L× W × H): 163mm×46.5mm×110mm
	Weight: 1.0kg
Industry Standard	EMI:FCC CFR47 Part 15, EN55022/CISPR22, Class A EMS: IEC61000-4-2 (ESD): ±8kV (contact), ±15kV (air) IEC61000-4-3 (RS): 10V/m (80MHz-2GHz) IEC61000-4-4 (EFT): Power Port: ±4kV; Data Port: ±2kV IEC61000-4-5 (Surge): Power Port: ±2kV/DM, ±4kV/CM; Data

	Port: $\pm 6kV$ IEC61000-4-6(CS):3V (10kHz-150kHz); 10V (150kHz-80MHz) IEC60068-2-6 (Vibration) IEC60068-2-27 (Shock) IEC60068-2-32 (Free Fall)
Working environment	Working temperature: $-40\sim 75^{\circ} C$ Storage temperature: $-40\sim 75^{\circ} C$ Relative humidity: 5%~95%(no condensation)
Certification	CE, FCC, RoHS
MTBF	360,000 hrs
Warranty	3 years

Software specification

Buttons	AI Loop protect
	AI VLAN
Hardware watchdog	Support
Traffic Statistics	Support
Port energy saving	Support
DHCP	DHCP Snooping
VLAN	4K VLAN
	802.1Q VLAN, MAC VLAN ,IP VLAN
	Voice VLAN
MAC address table	Follow the IEEE 802.1d standard
	Support MAC address automatic learning and aging
	Support static, dynamic, filtering address table
	Password protection

Safety features	Support user access based on port number, IP address, and MAC address
	HTTPS, SSL V3, TLS V1, SSH V1/V2
	Support IP-MAC-PORT ternary binding
	Support ARP protection, IP source protection, DoS protection
	Support DHCP Snooping and DHCP attack protection
	Support 802.1X authentication, AAA
	Support port security, port isolation
	Support CPU protection
QoS	Support 8 port queues
	Support port priority, 802.1P priority, DSCP priority
	Support SP, RR, WRR, priority scheduling algorithm
Spanning tree	Support STP(IEEE 802.1d), RSTP(IEEE 802.1w) and MSTP(IEEE 802.1s) protocol
	Support loop protection, root bridge protection, TC protection, BPDU protection, BPDU filtering
Multicast	Support IGMP v1/v2 Snooping
	Support fast leave mechanism
	Support multicast VLAN
	Supports multicast filtering, packet statistics, and unknown multicast discards
Storm suppression	Support for multicast suppression
	Support broadcast suppression
	Support for unknown unicast suppression
Link aggregation	Support static aggregation
	Support dynamic aggregation
	Support IP, MAC, and hybrid load balancing modes
	Supports up to 32 aggregation groups
IPv6	Support IPv6 Ping, IPv6 Tracert, IPv6 Telnet

	IPv6 SSH, IPv6 SSL
Management and maintenance	Support web management (HTTP, HTTPS, SSL V3)
	Support CLI (Telnet, SSH V1/V2, local serial port)
	Support SNMP V1/V2/V3,
	Support LLDP, RMON
	Support ARP protection, IP source protection, DoS protection
	Support CPU monitoring, memory monitoring
	Support system log, grading warning
	Support Ping, Tracert detection, cable detection