



CURVE Mouse
2.4 GHz wireless



Quick Installation Guide

81170

Products Features

- World general 2.4G wireless solution
- Maximum 1600DPI and 3 DPI available for adjustment
- Ergonomic design.
- Build-in Super nano receiver.

Products Installment

Get wireless mouse and receiver from package
Put 2pcs A AA alkaline battery properly in mouse.

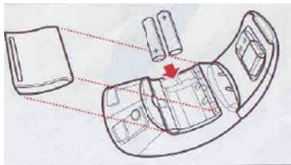

Connect the nano receiver with computer USB port

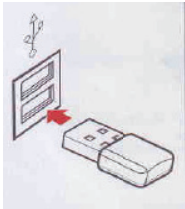

LED light flickers for several seconds, then you can use.

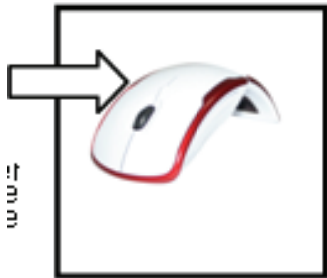

Advanced Function

1. DPI adjustable function

Fixed solution: 800DPI, adjustable among 800/1200/1600 DPI. Press the DPI button on the top of mouse to experience different speed, the LED will blink 1 time on 800DPI, blink 2 times on 1200DPI, blink 3 times on 1600DPI.

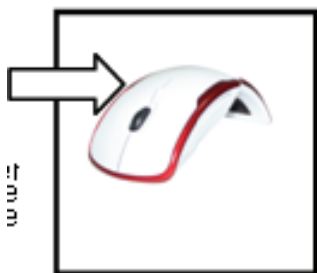

2.Low power indicating function

After a long time mouse using, the battery voltage will get lower, when lower than the settled low power indicating, the LED light would turn on red light to remind you change new battery.

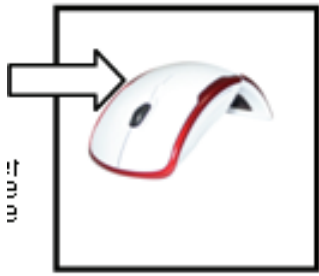

Notice: Only AAA alkaline battery is acceptable for using

3.Auto sleep function

It will come into the status of sleep automatically without mouse using for 8 minutes, saving more power. Press any keys for continuing use

Notice: If long time no use, please take out the battery, for fear of parts corrosion

4. Build in receiver

Using super nano receiver, can be connected with PC & Notebook for a long time, no any effects for computer. Plug the receiver back into mouse for easy taking and for fear of missing.

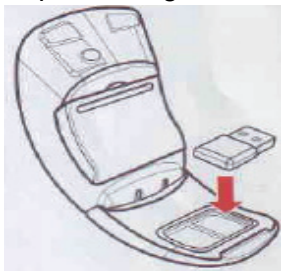

Reconnection

Both of mouse and Nano receiver has a built-in code, it can be setting one mouse to one receiver. Mouse and receiver need to

reconnect under the condition of High temperature, high magnetic, strong vibrate.

1. Plug off the nano receiver from USB port, and plug it on
2. Move RF mouse within 50 cm to nano receiver, re-install the battery, the above operation must be completed around 15 seconds. The mouse will re-connect automatically,
3. Mouse will ready to work after reconnection, press any key to check your connection successfully or not.

Announcement

Adopt optical as mouse motion detect, in compliance with related safety regulation
Adopt 2.4GHZ radio wave for data transmitting, use distance 5-7 meters if big block

Warning

Without the approval of the authorities to make any change or amendment, we have the right to prohibit user operating this equipment

Remarks

This device is complied with digital equipment level restriction of B and provisions article 15 of the FCC. This provision requires reasonable anti-interference protection in residence place. This device will transmit radio waves when using, Installment should be in accordance with instructions, and otherwise it may make harmful interference for wireless communication. And no guarantee whether interference will occur in a particular equipment or not. If this device really affects the signal of Radio or TV, you may switch off this device and adjust again. Recommend users to eliminate interference through one of the following methods.

- Remove receiving antenna,
- Increasing the distance between the equipment and the receiver
- Connect this device to the circuit differ from receiver
- Consulting the dealer or asking experienced radio/TV technician for help.