

Signature	Revision History	Date	Rev.
LIBRA	For Bulk Production	May 25, 2011	01

1 2 3 4 5 6 7

A HDMI A TYPE MALE

RoHS Compliant

B HDMI C TYPE MALE

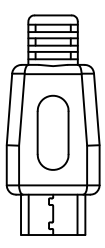
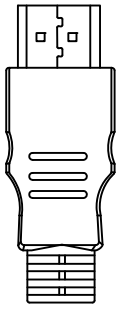
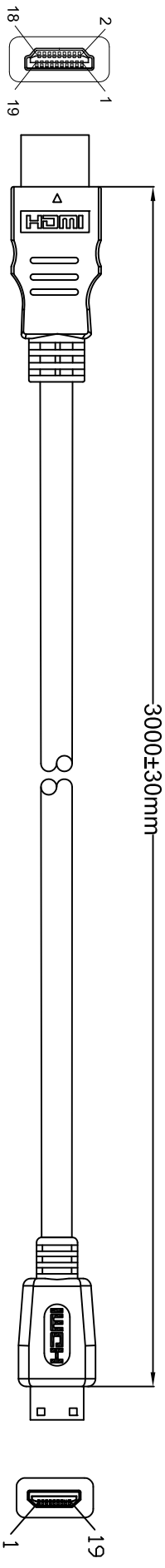

Package Details

P/N	Cable Length	Rolling Size (Single Cable)	Polybag Type (Single Cable)	Bag Size (Single Cable)	Article Weight (Single Cable)
AK-330106-030-S	3m	160 mm max.	Ordinary Polybag (Heat Sealed)	240*160*0.05mm	0.125kg

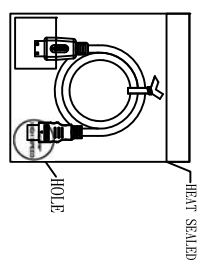

Inner Packing Unit

P/N	Cable Length	Quantity (Inner Packing Unit)	Type (Inner Packing Unit)	Size (Inner Packing Unit)	Weight (Inner Packing Unit)
AK-330106-030-S	3m	10 pcs	Polybag (Heat Sealed)	400*350*0.05mm	1.27kg

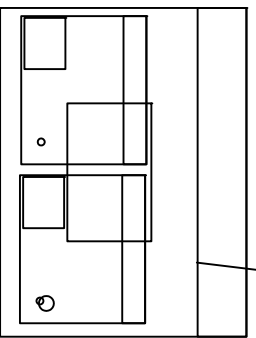

P1	P2	CABLE FUNCTION
1	2	TMDS Data2+
2	3	TMDS Data2-
3	4	TMDS Data2- Shield
4	5	TMDS Data1+
5	6	TMDS Data1-
6	7	TMDS Data1- Shield
7	8	TMDS Data0+
8	9	TMDS Data0-
9	10	TMDS Data0- Shield
10	11	TMDS Clock+
11	12	TMDS Clock-
12	13	TMDS Clock- Shield
13	14	CEC
14	15	Reserved(N.C. on device)
15	16	SCL
16	17	SDA
17	18	DDC/CEC Ground
18	19	+5V Power
19		Hot Plug Detect
Shell	Shell	Ground

CARTON DETAILS

P/N	Cable Length	Quantity (Carton)	Measurement (Carton)	N.W. (Carton)	G.W. (Carton)
AK-330106-030-S	3m	60pcs	50*32*21.5cm	7.5kg	8.5kg

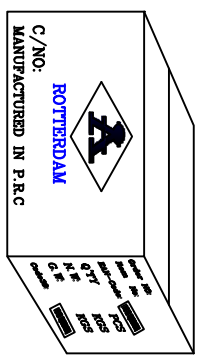

Drawn by	Date	Name
May 25, 2011	Libra	
Checked by		
Approved by		

ASSMANN
Electronic GmbH

Part No.	AK-330106-030-S
EAN:4016032295860	
Title	HDMI A/M - C/M CABLE
Scale	N/A
Unit	MM
Sheet	1/1

* "ROTTERDAM" is for Sea Freight shipment
 * "COLOGNE" is for Air Freight shipment
 * "LUDENSCHIED" is for Fedex or UPS shipment

STxxxxx

H	1	2	3	4	5	6	7	H
G								G
F								F
E								E
D								D
C								C
B								B
A								A